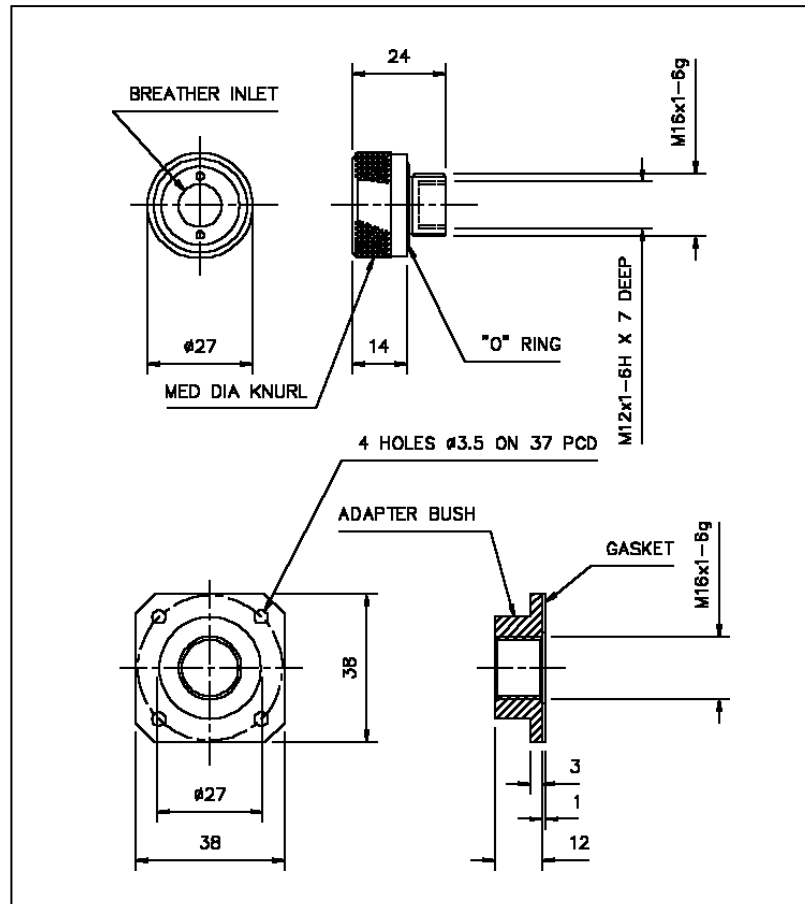

DRAIN PLUG AND PANEL BUSH ADAPTOR**DESCRIPTION**

A Drain Plug and flanged bush adaptor provided for fixing to panels and equipment to enable the drain plug to be mounted and de-mounted from outside of the equipment.

APPLICATIONS

Ideally suited for mounting Drain Plugs, which require removal without opening the equipment. Their use affords the minimum protrusion within the equipment and allows unimpeded flow of fluid due its under flush mounting.

PART NUMBER

BL/D6636/01

MATERIAL

Plastic (Polycarbonate)

COLOUR

Black

OPERATING TEMPERATURE

Maximum 70°C

Minimum -40°C

ENVIRONMENTAL PROTECTION	Resistant to Alcohols, Ethers, weak acids and bases.	
ADAPTOR THREAD SIZE	M16 x 1 - 6g	
TIGHTENING TORQUE	(Of Drain Plug)	2Nm
PACKAGING	Sealed polythene bag.	

Designed and manufactured by: -

BROWNELL LTD
UNIT 2
ABBAY ROAD INDUSTRIAL PARK
COMMERCIAL WAY
LONDON NW10 7XF
Tel 020 8965 9281
Fax 020 8965 3239
E-mail info@brownell.co.uk
Web site <http://www.brownell.co.uk>

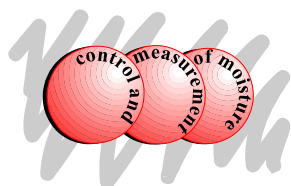

Issue 2 21/10/98
Ref prspec22