

DRG No  
BL/D9215/01-06 INST

USED ON

THIRD ANGLE PROJECTION

REMOVE ALL SHARP EDGES UNLESS SPECIFIED

DO NOT SCALE - ASK

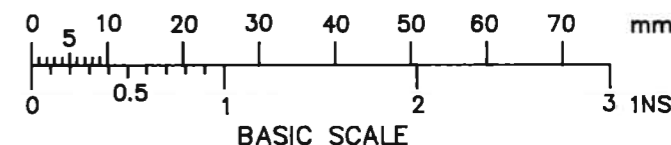

NOTES UNLESS OTHERWISE SPECIFIED:

1. NOMENCLATURE: VALVE, BREATHER, TWO-WAY RELIEF WITH MANUAL RELEASE BUTTON.
2. APPLICABLE SPECIFICATION: SAE AS27166, TYPE III.
3. MATERIAL:
  - 3.1 HOUSING AND HEX NUT: ALUMINUM DIE CASTING IAW QQ-A-591.
  - 3.2 WASHER AND COVER: ALUMINUM ALLOY.
  - 3.3 GASKET: SILICONE RUBBER IAW ZZ-R-765, CLASS 2A OR 2B, GRADE 60.
4. FINISH:
  - 4.1 HOUSING AND HEX NUT: ANODIZE IAW MIL-A-8625, TYPE II, CLASS 1. (DARK COLOR DUE TO ALLOY).
  - 4.2 WASHER: CONVERSION COATED IAW MIL-C-5541, CLASS 1A.
5. THE FOLLOWING ITEMS FURNISHED AS PART OF THIS ASSEMBLY MAY BE PURCHASED SEPARATELY:

P/N BL/D9216      WASHER  
 BL/D9217      GASKET  
 BL/D9218      HEX NUT

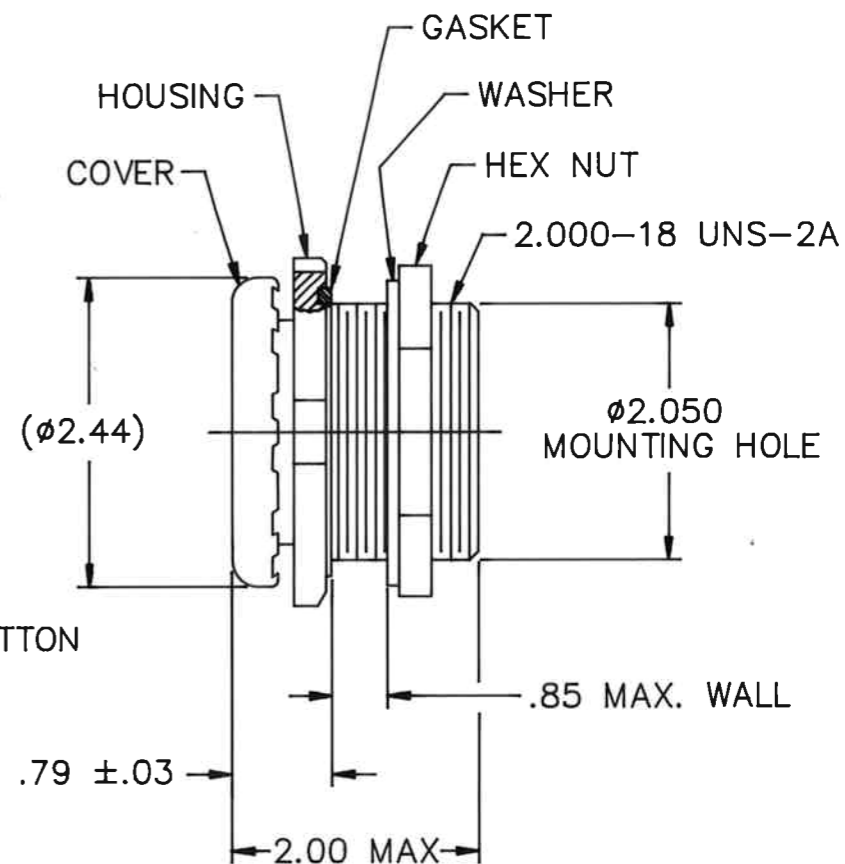
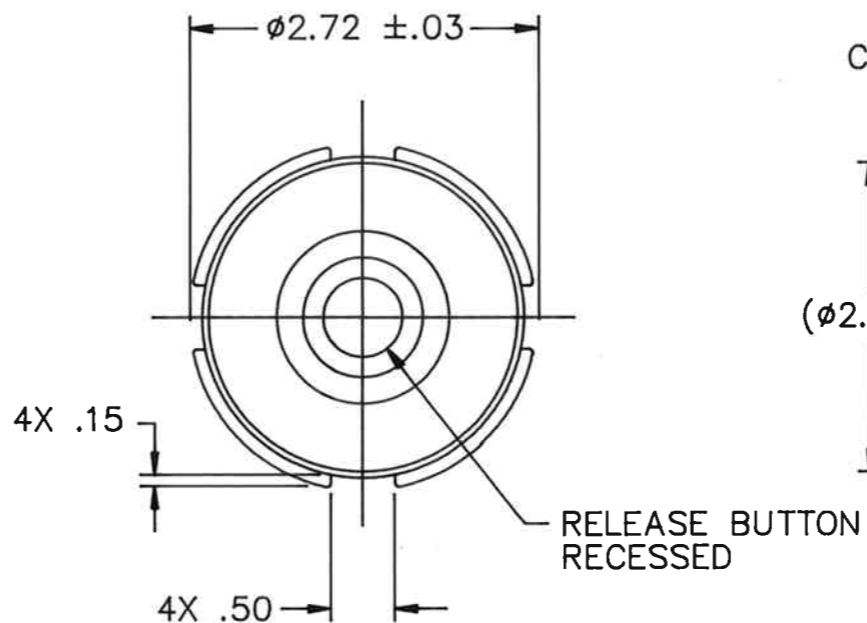

AIR FLOW "P" ← (OUT OF CONTAINER)  
 AIR FLOW "V" → (INTO CONTAINER)

DRG No	PRESSURE SIDE (FLOW OUT)		VACUUM SIDE (FLOW IN)	
	SEALED @	MIN FLOW RATE @ PRESSURE	SEALED @	MIN FLOW RATE @ PRESSURE
BL/D9215/01	0.5 PSID	20 SCFM @ 2.0 PSID	0.5 PSID	25 SCFM @ 2.0 PSID
BL/D9215/02	1.0 PSID	18 SCFM @ 2.5 PSID	1.0 PSID	23 SCFM @ 2.5 PSID
BL/D9215/03	1.5 PSID	16 SCFM @ 3.0 PSID	1.5 PSID	21 SCFM @ 3.0 PSID
BL/D9215/04	2.0 PSID	14 SCFM @ 3.5 PSID	2.0 PSID	19 SCFM @ 3.5 PSID
BL/D9215/05	2.5 PSID	12 SCFM @ 4.0 PSID	2.5 PSID	17 SCFM @ 4.0 PSID
BL/D9215/06	3.0 PSID	10 SCFM @ 4.5 PSID	3.0 PSID	15 SCFM @ 4.5 PSID

		A	1/5/02
CHANGE	MOD No	ISSUE	DATE

MATERIAL 3.	PROTECTIVE FINISH 4.	TOLERANCES DECIMALS .XX ±.015 .XXX ±.010 ANGLES ±0.5°	CUSTOMER BROWNELL Ltd. LONDON NW10	CUSTOMER'S REF	DRAWN LJ	CHECKED A
EST. WT. —		DIMENSIONS IN INS/mm   INS SCALE (ORIGINAL)   N.T.S	TITLE VALVE, BREATHER TWO-WAY RELIEF	DRAWING NUMBER BL/D9215/01-06 INST		